

Application areas

Drinking water supply for:

- > Domestic kitchens
- > Public areas
- > Offices
- > Cafeterias / bistros
- > Restaurants / hotels



Water system

Zip HydroTap® G4 CS

Product information



chilled + sparkling >   **G4 CS 175**

Part number:	4100-44582
Number of users:	< 50
Water connection (thread connection):	G ½" or G ¾" *
Rated pressure [bar]:	2.5 – 7.0
Chilled water temperature [°C]:	5 – 10
Chilled water capacity [glasses ¹⁾ / h]:	175
Standby power consumption [kWh / 24h]:	0.21
Nominal power at voltage 1~/N/PE 230 V AC [kW]:	0.45  with plug
Compact undersink unit [colour]:	white
Protection class:	IP 20
Weight (filled) [kg]:	20
Dimensions height × width × depth [cm]:	33.5 × 34.0 × 47.6

*) Connection hose G ½" with supplied adapter G ¾" 1) Standard glass with 200 ml

Description

- > Undersink water system, dispenses filtered chilled still or sparkling drinking water for direct connection to the water supply
- > Touch display for menu navigation and for activating the energy saving modus as well as temperature setting of the water
- > Electronic temperature control
- > Easy-to-replace sub-micron particle filter cartridge with activated carbon filter, filters hazardous substances > 0.2 micron and improves the taste of water
- > Leakage protection system
- > Various electronic taps with safety function and button operation selectable

Note on carbonation function ^{H) SH)}

The CO₂ bottle for producing sparkling water is not included in the scope of supply. This is obtainable from retail outlets or specialist gas dealers. Pressure reducers are available for either SodaClub CO₂ bottles or standard commercial CO₂ bottles with W 21.8 × 1/14 RH thread.

Profitability comparison (Source: Internet comparison, 18.11.2018)

The comparison shows the total costs of the various systems including purchase, energy and maintenance costs over 5 years of use in Germany. Ideal for use in the office.

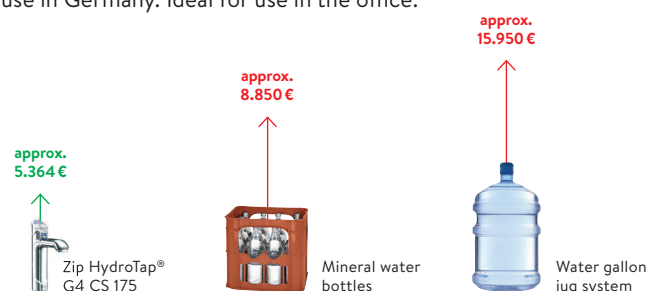

Calculation basis

Number of users:	15 persons
Number of days in use:	230 working days per year
Usage:	0.9 litres / person and day
Drinking water costs:	4 € per 1.000 litres
Mineral water bottles:	570 € per 1.000 litres
Water gallon jugs:	950 € per 1.000 litres

H) Note: the total quantity of sparkling water depends on the CO₂ bottle used. The carbon dioxide content is a maximum of 5 g per litre, corresponding to medium sparkling water.

SH) Safety note: It must be ensured that an uncontrolled escape of CO₂ gas cannot build up to a hazardous level. There must be a minimum room space of 6.8 square metres per 1 kg CO₂ with a ceiling height of 2.5 m.

Water system

Zip HydroTap® G4 CS

Installation



Daily user requirements and the available space in the cabinet below the selected special tap should be considered when selecting the appropriate model. The example below shows the installation with Zip HydroTap® G4 CS 175.

Measurements in mm

Assembly and operating instructions must be observed upon installation.

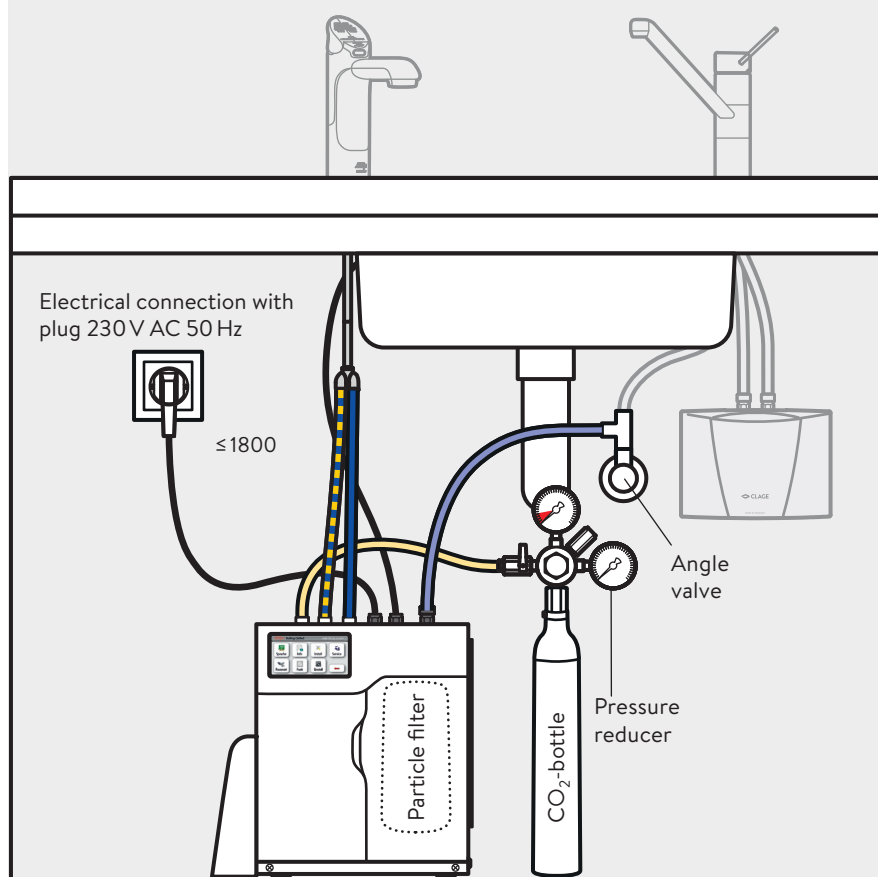

Unit dimensions:
(height × width × depth)

Zip HydroTap® G4 CS175
335 × 340 × 476 mm

Top clearance for undersink unit
(lower edge sink or drawers)
min. 200 mm

Right and left clearance for unit
min. 50 mm

Water system Zip HydroTap® G4 CS Installation



Option 1: Tap “Classic CS”

Measurements in mm

For the operation of the water system Zip HydroTap® G4 CS you need a suitable tap, for example the tap “Classic CS”.

Assembly and operating instructions must be observed upon installation.

NEW!

Now also available as **Touch-Free** option with IR sensors for no-touch operation.

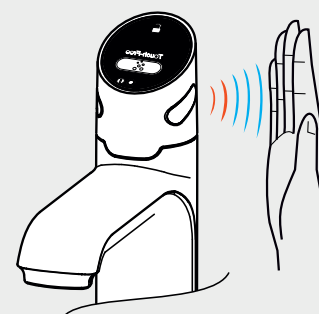

Drill hole diameter
for the tap

$\varnothing 35.5$
max. 50
min. 25

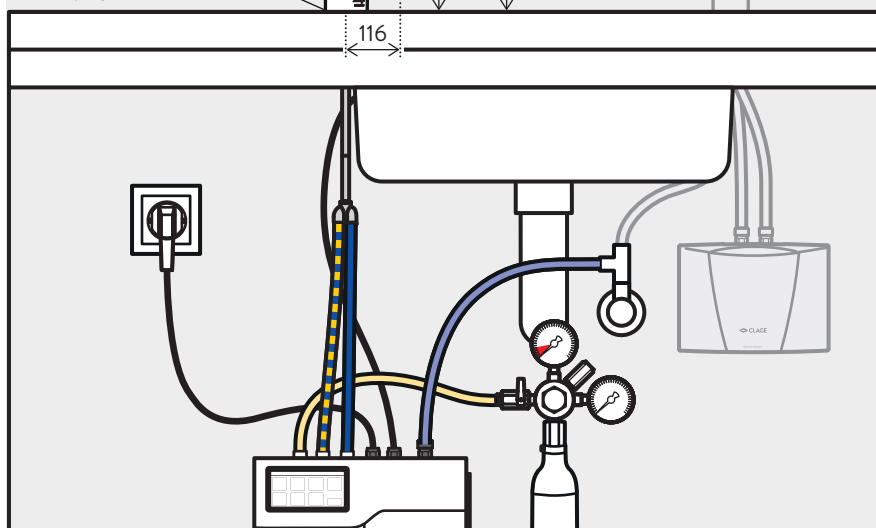
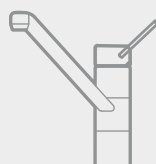
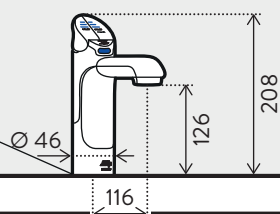

Installation at the kitchen sink



Installation as stand-alone unit with drainage front and extension KXTV.



Water system Zip HydroTap® G4 CS Installation

Option 2: Tap “Arc CS”

Measurements in mm

For the operation of the water system Zip HydroTap® G4 CS you need a suitable tap, for example the tap “Arc CS”.

Assembly and operating instructions must be observed upon installation.

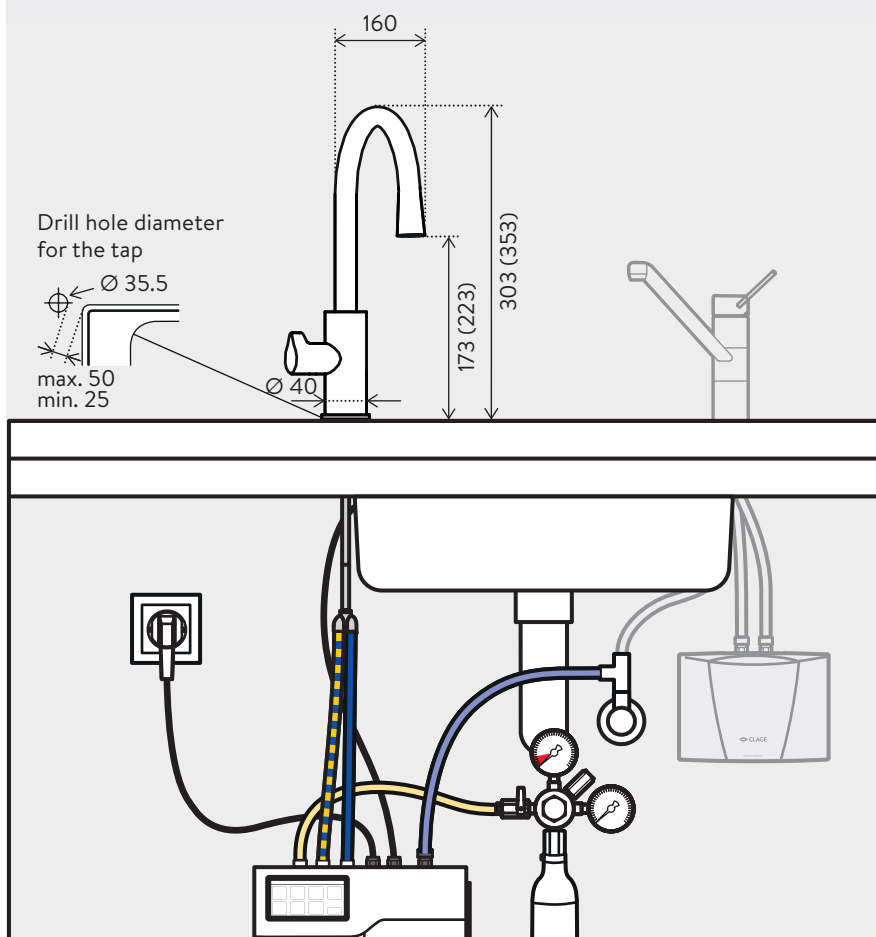

Flexible alignment

The Arc can be installed for left and right hand operation and the pipe outlet can be fixed at various angles and heights.

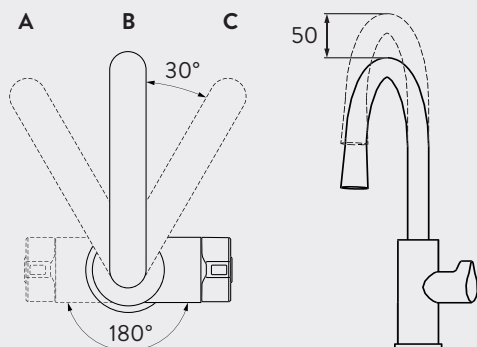

Installation as stand-alone unit with drainage front.



Water system

Zip HydroTap® G4 CS

Taps



Zip Classic CS

Electronic dispensing tap for Zip HydroTap® CS with operating keys at the top, function indicator, holding function for easy canister filling, fixed spout 12 cm, height 21 cm, drill hole with 35 mm diameter required.

Classic CS, polished chrome: Part no. 4100-44518
Classic CS, brushed chrome: Part no. 4100-44519
Classic CS, matte black: Part no. 4100-44520



Zip Arc CS

Electronic dispensing tap for Zip HydroTap® CS with operating lever on the side, function indicator, holding function for easy canister filling, fixed spout 16 cm, height 35.3 cm, drill hole with 35 mm diameter required.

Polished chrome **Arc CS:** Part no. 4100-44521
Brushed chrome **Arc CS:** Part no. 4100-44522
Matte black **Arc CS:** Part no. 4100-44523



Zip Touch-Free CS

Electronic dispensing tap for Zip HydroTap® CS with IR sensors and function indicator for hygienic, no-touch operation, fixed spout 12 cm, height 21 cm, drill hole with 35 mm diameter required.

Touch-Free CS, polished chrome: Part no. 4100-44544

Water system

Zip HydroTap® G4 CS

Accessories



KXF 2.1 (included)

Sub-micron particle filter cartridge filters contaminants > 0.2 microns and additionally improves the taste of the water.
For Zip HydroTap® G4 models from 02.2017.

KXF 2.1: Part no. 893702



KXV for Classic (optional)

The optional extension for raising the electronic dispensing tap Zip Classic by 13.5 cm.

KXV 10, polished chrome: Part no. 4100-44165

KXV 20, brushed chrome: Part no. 4100-44166

KXV 40, matte black: Part no. 4100-44167



KXTV for Classic (optional)

The optional stainless steel font with drainage connection and extension allows for flexible installation of the electronic dispensing tap at any location away from the sink.

KXTV 10, polished chrome: Part no. 4100-44565

KXTV 20, brushed chrome: Part no. 4100-44566

KXTV 40, matte black: Part no. 4100-44567



KXTV for Arc (optional)

The optional stainless steel font with drainage connection allows for flexible installation of the electronic dispensing tap at any location away from the sink.

KXTV 50, polished chrome: Part no. 4100-44560

KXTV 60, brushed chrome: Part no. 4100-44561

KXTV 70, matte black: Part no. 4100-44562



DMBCS

Pressure reducer with standard CO₂ connecting thread (1/2 inch), gas cylinders can be obtained via specialist gas suppliers

DMBCS: Part no. 4100-44120

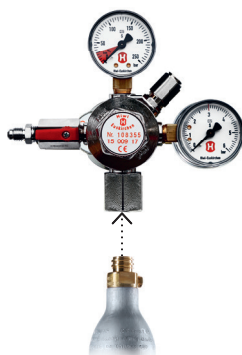

DMSP

Pressure reducer with Soda Club connecting thread.

DMSP: Part no. 4100-44125

COF (only available for dispatch within Germany)

CO₂ gas cylinder (charge 425 g) for Soda Club connecting thread.

COF: Part no. 9910-90005



KXB-C (optional)

Plastic installation kit for G4 CS175, allows for easier installation of ventilation in the base cabinet. Dimensions (H × W × D): 4.0 × 49.5 × 50.0 cm.

KXB-C: Part no. 893541



DTK (optional)

The digital temperature controller for Zip devices is used to keep the temperature in the cupboard below 35°C when normal ventilation is not sufficient. The digital controller operates independently of the undersink unit and will require a separate 230 V socket.

DTK: Part no. 893159